



Annual Report

FISCAL YEARS 2012 AND 2013

EDUCATION FOR A HEALTHY PLANET

The Hitchcock Center for the Environment's mission is to foster a greater awareness and understanding of our environment and to develop environmentally literate citizens.

Annual Report

FISCAL YEARS 2012 AND 2013

TABLE OF CONTENTS

Letter from the Executive Director	I
Our Path to Environmental Literacy	2
Volunteer & Community Engagement	10
50th Anniversary	12
Our Supporters	16
Financial Report	21



STAFF MEMBERS

Julie Johnson, *Executive Director*
Casey Beebe, *Community Programs Coordinator*
Susan Heitker, *Development and Communications Coordinator*
Colleen Kelley, *Education Director*
Katie Koerten, *Environmental Educator, Children and Family Programs Coordinator*
Micky McKinley, *Environmental Educator, Resource Center Coordinator*
Patty O'Donnell, *Environmental Educator*
Jessica Schultz, *Center Coordinator*
Helen Ann Sephton, *Environmental Educator, School Programs Coordinator*
Jennifer Unkles, *Bookkeeper*
Ted Watt, *Naturalist and Environmental Educator*

SUMMER CAMP COUNSELORS

Sandra Alton, Robert Barron, Rebecca Brown, Abbe Hamilton, Keegan Kuvach, Leigh Pratt, Patrick O'Roark, Alia Woofenden

BOARD MEMBERS

OFFICERS

Jaana Cutson*
President FY12 & 13
Nancy Eddy
Clerk FY12 & 13
Sarah la Cour
Vice-President FY13
Marie Hess
Treasurer FY12 & 13
Martha Hoopes*
Vice-President FY12

MEMBERS-AT-LARGE

Danielle Barshak**
Penny Beebe*
Jim Brassord*
Casey Clark
Michael Dover*
Caroline Hanna
John Kowaleski
Kate Lamdin
Susan Loring-Wells
Bob Saul*
Michael Schwartz**
Lisa M. Sihvonen-Binder

Sonya Sofield*
Pamela Stone
Pete Westover*
Larry Winship*
Dan Ziomek**

EX-OFFICIO

Harvey Allen, *Conservation Commission Liaison*
Julie Johnson, *Executive Director*

* Board term ended in FY12 or FY13
** Joined Board in FY13



**Hitchcock Center
for the Environment
at Larch Hill
Conservation Area**

525 South Pleasant Street
Amherst, MA 01002
413-256-6006
Hours: Tuesday–Friday
9:00 AM–4:00 PM
www.hitchcockcenter.org

Letter from the Executive Director

Dear Hitchcock Friends,

We are pleased to share with you our accomplishments for fiscal years 2012 and 2013, including our historic 50th Anniversary year. With your generosity, we were able to help thousands of people from a diverse range of communities and perspectives gain new understanding of and greater connection to the natural world.

We could not accomplish all that we have without you. Our deep base of support through gifts, grants, sponsors, members, partners, and volunteers has made the Hitchcock Center what it is today—a nationally recognized leader in the field of environmental education.

We pay tribute to all of you in the pages of this report. Thank you for keeping Hitchcock strong and for recognizing the importance of environmental education.

With gratitude,

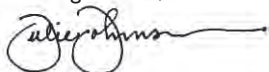

Julie Johnson
Executive Director

A Quick Snapshot	FY12	FY13
Total program participants served	6,417	8,473
Children, youth and family participants	1,009	1,113
K–12 student participants	4,326	5,946
Professional development participants (teachers and student teachers)	183	266
Adult participants	899	1,148
Schools, colleges, universities and organizations served	71	83
Urban and rural communities represented	64	61
Percent low income served (K–12 school programs only)	35%	30%

GEOGRAPHIC REGION SERVED

Hampshire County	66%	57%
Hampden County	19%	29%
Franklin County	14%	13%
Other	1%	1%

We wish to thank our Premier and Sustaining Business Sponsors for their generous annual support.

FY12

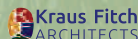

KirschLeuchs Consulting



FY13

KirschLeuchs Consulting

INTEGRITY
DEVELOPMENT & CONSTRUCTION, INC.





DEFINING ENVIRONMENTAL LITERACY

An environmentally literate person understands:

- Our daily choices affect our environment;
- How our choices can help or harm our environment;
- What we need to do—individually or as part of a community—to keep our environment healthy and sustain its resources, so that people enjoy a good quality of life for themselves and their children.

Our Path to Environmental Literacy

Our environmental education programs help teachers and their students, children and their families, and adults and their communities understand the complex ecological concepts, principles, and systems that are essential to a healthy planet and our quality of life. Our major program areas include: Children, Youth & Family, K–12 School, Professional Development, Adult, and Intern & Leadership Training Programs.



Our Children, Youth and Family Programs ...

inspire young people and their families through hands-on environmental education experiences embedded in the outdoors.

CHILDREN, YOUTH AND FAMILY PROGRAMS

	FY12	FY13
Total program participants	1,009	1,113
Children (ages 3–5)	181	174
Children (ages 6–12)	531	656
Youth (ages 13–18)	12	13
Parents & caregivers	285	270
Total unique programs	40	48
Total camp scholarships	10	10

Programs include: Nature Discovery Preschool, Summer and Vacation Camps, Afterschool, Homeschool,



discovery

joy

“We love hearing about a new creature every day from our little naturalist!”

—Hitchcock parent

**CHILDREN, YOUTH
AND FAMILY PROGRAM
THEMES INCLUDE:**

Amazing Adaptations
Amphibians of Spring
Animal Survival Strategies
Beanstalks to Butterflies
Clues to Nature's Past
Ecology is Everywhere
GPS in the Wild
Hideouts and Habitats
Hurray for Herps!
Maps, Compasses and Treasure
Nature of Autumn
No Place Like Home
Our Rainbow World
Prehistoric Preschool
Quest for Winter Survival
Simple Machines
Soil, Seeds and Sun
Spectacular Salmon
Spineless Wonders
The ABCs of Living Green
The River in Our Backyard
What Would Nature Do?

K-12 SCHOOL PROGRAM THEMES INCLUDE:

Amazing Animal Adaptations
Animals in Winter
Ecology of Salmon in the Connecticut River
Energy Investigations
Forest Ecology
Fungi!
Habitat Studies
Habitats of Larch Hill
Insect Investigations
Life in a Pond
Live Animal Inquiry
Mountains and Valleys
Predators and Prey
Small Animals in the Classroom
Technology of Winter
The Connecticut River: Wildlife and Water
Wild About Water

Our K-12 School Programs ...

provide students with experiential, interdisciplinary physical, earth, life and environmental science curricula using the local environment as an engaging learning lab.



ecological understanding

Our Professional Development Programs ...

are designed to give educators the confidence, motivation, and skills they need to integrate science, ecology and environmental sustainability topics into their curricula.

K-12 SCHOOL PROGRAMS

	FY12	FY13
Total program participants	4,326	5,946
Pre-K students	160	230
Elementary students	4,166	5,614
Middle & high school students	40	82
Schools served	35	45
Total classrooms	80	108
Total unique programs	156	202
Total fieldtrips	87	99

PROFESSIONAL DEVELOPMENT PROGRAMS

	FY12	FY13
Total program participants	183	266
Teachers	133	196
Student teachers	50	70
Total unique programs	7	10

Programs include: Classroom, Field Trip, Naturalist-in-Residence, Curriculum & Professorial Development, and Schoolyard

Our Adult Education Programs ...

taught by local experts and Hitchcock educators, seek to encourage life-long learning in environmental literacy, awareness and action.

Our Intern and Leadership Training Programs ...

enable youth and college students to enhance their civic, academic, and professional engagement in environmental fields of study.

JUNIOR CAMP COUNSELORS
Emelia Aiken-Hafner
Kira Cairn
Maia Callahan
Trevor Coloumbe
Darien DeWalt
Dharam Bir Khalsa
Carys Lamberg
Colin McLean
Aidan Mulvihill
Zofia Noble
Brooke Offin
Sam Rosenberry

Bradley Sherwood
Christine Sherwood
Alex Sieracki
Leilani Trimble
Kin Wildman-Hanlon
Orlando Wildman-Hanlon
Emma Zyskowski

AFTERSCHOOL INTERNS
Katy Hofmeister
(Hampshire College)
Sana Jameel
(University of Massachusetts)
Nere Kapiteni
(University of Massachusetts)
Kate Rydell
(Mount Holyoke College)

HOME SCHOOL INTERNS
Corrin Meise-Munns
(Marlboro College)
Diana Ngai
(Mount Holyoke College)
Lorian Tonna-Lamuniere
(Antioch New England)

PRE-SCHOOL INTERNS
Katy Hofmeister
(Hampshire College)
Diana Ngai
(Mount Holyoke College)
Anna Yoors
(Hampshire College)

INDEPENDENT PROJECT INTERNS
Eliza Fishman
(Amherst High School: School to Career—Story Walk)
Terra Fletcher
(Hampshire College: Exhibit on Native Wildlife Habitat)

ADULT EDUCATION PROGRAMS

	FY12	FY13
Total program participants	899	1,148
Total unique programs	44	50

ADULT PROGRAMS INCLUDE:

Citizen Science
Natural History
Living Sustainably
Environmental Issues
Green Building
Community Collaboration
Natural Systems

scientific awareness

systems thinking

INTERN & LEADERSHIP TRAINING PROGRAMS

	FY12	FY13
Total participants	17	19
Junior camp counselors	12	13
Program interns	5	4
Project interns	n/a	2





Program Highlights

NEW YOUTH BIRDING COURSE ENGAGES YOUNG BIRDERS

Thanks to expert local birder and Board member Dan Ziomek, the Hitchcock Center piloted a new youth birding course in Spring, 2013. Dan led eight young students ranging in age from 8 to 12 in the early hours of the morning over a five-week period to hone their skills in bird identification and behavior. We are extremely thankful for Dan's dedication and interest in developing the next generation of birding enthusiasts who can serve as future experts working on behalf of our feathered friends.

FACING CLIMATE CHANGE WITH HOPE

Climate activist Reverend Margaret Bullitt-Jonas led an inspirational program for 16 people on May 30, 2013 aimed at instilling hope, not despair, during a time of unprecedented ecological crisis. This program is one of a series of programs that the Hitchcock Center is building upon to help people develop a "framework of being" that allows them be effective healers, leaders and change agents filled with compassion, creative energy, scientific understanding, and spiritual strength to champion equitable, healthy, sustainable, and peaceful solutions to climate change.

lifelong learning

CENTER FOR TALENTED YOUTH PARTNERS WITH HITCHCOCK CENTER

The Johns Hopkins Center for Talented Youth program, which identifies and develops the talents of advanced K-12 learners, brought over 50 gifted students from around the Northeast to the Hitchcock Center for an unprecedented two years in a row for workshops in geology, birds of prey, and pond ecology.

community engagement

NEW STEM (SCIENCE, TECHNOLOGY, ENGINEERING, MATHEMATICS) LEARNING OPPORTUNITIES

Thanks to a multi-year National Science Foundation grant, Hitchcock Education Director Colleen Kelley partnered with the UMass Amherst School of Education to work with 20 master teacher fellows and 20 teacher fellows in Greenfield, Holyoke, Springfield and Mahar school districts. Through teacher summer training institutes, in-class mentoring, afterschool activities, and curriculum development, Colleen assisted teachers with the integration and implementation of new inquiry-based and culturally

responsive Science Technology Engineering and Math learning opportunities that engaged over 950 students in grades 6–12.

Special thanks goes to Dr. Kathleen Davis, Associate Professor, Department of Teacher Education & Curriculum Studies, for her leadership and commitment to excellence in science and environmental education and community partnership development.

MOUNTAIN LIONS, MAMMALS AND MORE

The Hitchcock Center was proud to partner with Mass Audubon's Arcadia Sanctuary to bring natural history and tracking expert Sue Morse to the Valley over a two-day period on February 22–23, 2013. This special event was sold out with over 44 people immersed in the natural world and learning more about some of our most fascinating and beloved mammals including cougar, porcupines, fishers, bear, moose, and more.

NEW NATIONALLY RECOGNIZED SCIENCE CURRICULUM

A grant award from the New England Environmental Education Alliance and the Environmental Protection Agency supported a team of Hitchcock educators to develop three comprehensive classroom-ready curriculum units using the Next Generation Science Standards (NGSS). The NGSS are based on the latest research by the National Research Council, the National Science Teachers Association, and the American Association for the Advancement of Science on the most effective K–12 science learning approaches. This curriculum will now be piloted, published, and implemented in classrooms throughout the region and include: The Pond Ecosystem (grade 3), Energy is Electrifying! (grade 4), and The Hydrosphere, Water, and How We Use It (grade 5).

stewardship

change



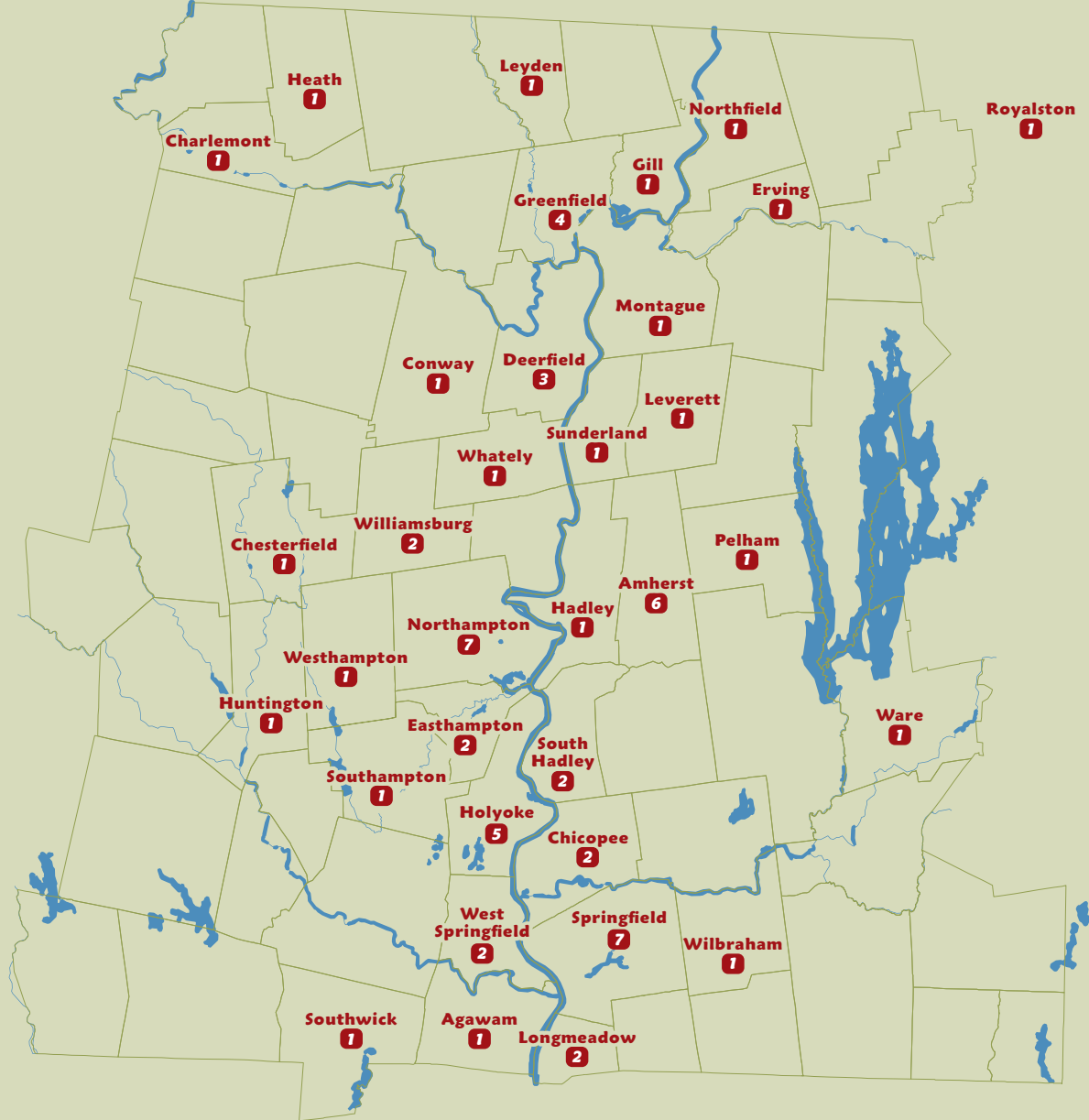

K-12 School Programs—Schools & Communities Served In FY12 & FY13

The Hitchcock Center served 66 schools in 34 communities within western Massachusetts during fiscal years 2012 & 2013.

FRANKLIN COUNTY

Charlemont

Hawlemont Elementary School

Conway

Conway Grammar School

Deerfield

Bement School

Deerfield Elementary School

Old Deerfield Nursery School

Erving

Erving Elementary School

Gill

Gill Elementary School

Greenfield

Academy of Early Learning

Greenfield High School

Greenfield Middle School

Math & Science Academy

Heath

Heath Elementary School

Leverett

Community Network for Children

Leyden

Pearl Rhodes Elementary School

Montague

Montague Elementary School

Northfield

Northfield Elementary School

Sunderland

Sunderland Elementary School

HAMPDEN COUNTY

Agawam

Roberta J. Doering School

Chicopee

St. Joan of Arc School

St. Stanislaus School

Holyoke

Maurice A. Donahue Elementary School

E.N. White Elementary School

Kelly Elementary School

William G. Morgan School

Lt. Clayre P. Sullivan School

Longmeadow

Center School

Wolf Swamp Road School

Southwick

Powder Mill Middle School

Springfield

Academy Hill School

Balliet Elementary School

Balliet Middle School

Brunton School

Margaret C. Ellis School

MLK Charter School

St. Michael's Academy

West Springfield

Faussey Elementary School

Tatham Elementary School

Wilbraham

Stonyhill School

HAMPSHIRE COUNTY

Amherst

Amherst Montessori School

The Common School

Crocker Farm School

Fort River School

Pioneer Valley Chinese

Immersion Charter School

Wildwood School

Chesterfield

New Hingham Regional

Elementary School

Easthampton

Neil A. Pepin School

Whitebrook Middle School

Hadley

Hadley Elementary School

Huntington

Littleville Elementary School

Northampton

Bridge Street School

Jackson Street School

Leeds Elementary School

Montessori School of Northampton

R.K. Finn Ryan Road School

Smith Campus School

Sunnyside Childcare Center

Pelham

Pelham Elementary School

South Hadley

Mosier Elementary School

Plains School

Southampton

William E. Norris School

WORCESTER COUNTY

Royalston

Royalston Community School

Fiscal Year 2012 Fiscal Year 2013

K-12 SCHOOL PROGRAMS

	FY12	FY13
Total program participants	4,326	5,946
% Franklin County	14%	13%
% Hampden County	19%	29%
% Hampshire County	66%	57%
% Other	1%	1%
Total unique programs	156	202
Total classroom programs	63	97
Total field trip programs	87	99
Total naturalist-in-residence programs	6	6
Total low income participants	1,509	1,800
% low income participants	35%	30%



Volunteer Engagement

Thanks to all our office, education, trail & garden, and special event volunteers and to all our community partners! Simply put, we could not do it without you!

Khadejah Ahmad
Emelia Aiken-Hafner
Harvey Allen
Alpha Phi Omega
(UMass)
Rema Boscov
Leslie Breger
Virginia Brewer
Margaret Bullitt-Jonas
Kira Cairn
Maia Callahan
Vivienne Carey
John Chamutka
Natalie Chamutka
Madeline Charnay
Brandon Chasson
Elena Cocchi
Bruce Coldham
Trevor Coloumbe
Comfort Family
Dan Conlon
Sarah Cooper
Bick Corsa
Artelia Court
Mary Cushing
Julie DeWalt
Summer DeWalt
Dari DeWalt
Nancy Dickinson
David Dunn

Mary Dunn
Ronna Erickson
Ted Elliman
Aaron Ellison
Madison Esposito
Howie Faerstein
Elizabeth Farnsworth
Ann Froschauer
Margaret Garipey
Emily Gedrey
Ken Gooch
Dave Gott
Lila Grallert
Sam Grinnell
Julie Gross
Hampshire College
Volunteers
Kripa Harper
Susan Heitker
Cheryl Herrell
Katie Hofmeister
Doris Holden
George Holt
Anne Homme
Martha Hoopes
Jamie Hoyle
Paul Ita
Marianne Jackus
Mathew Jacobson
Betsey Johnson
Nere Kapiteni
Kappa Phi Lambda (UMass)

Devon Kelting
Dharam Bir Khalsa
Maria Kopicki
John Kowaleski
Seal LaMadeleine
Carys Lamberg
Jan Lambert
Hans Leo
Susan Lewandowski
Bridgit Litchfield
Richard Little
Susan Loring-Wells
Carole Lynch
Lauren Lynch
Charles Mann
Eleanor Manire-Gatti
Bob Marstall
Eric Martin
Carolyn Mathews
Colin McLean
Peter McLean
Becky McNiven
Dee McWilliams
Malcom Meltzer
Joan Milam
Emily Monosson
Aidan Mulvihill
Diane Murch
Sandy Musprat
Jono Neiger
Kelly Nevin
Diana Ngai

Orin Nisenson
Zofia Noble
Marty Noblick
Marty Norden
Mickey Novak
Anne Novosel-Mileski
Patty O'Donnell
Brooke Offin
Omega Psi Delta (UMass)
Jan Ortiz
Sarah Partan
Phi Gamma Delta (UMass)
Nancy Putman
Charlie Read
Brian Reid
Kevin Reidy
Julie Richburg
Joe Roberts
Kelly Robinson
Joe Rogers
Sam Rosenberry
Sara Ross
Kate Rydell
Laurie Sanders
Alex Sciaruto
Alex Sieracki
Luke Sedor-Protti
Nick Shaw
Christine Sherwood
Bradley Sherwood
Greta Shultz
Beryl Singer

Helen Sitar
Susan Smith
Smith College Volunteers
Sara Snyder
Sonya Sofield
David Spector
St. Francis of Assisi
Volunteers
John Stoffolano
Jane Stein
Tom Sullivan
Eric Thompson
Eric Toensmeier
Leilani Trimble
Carol Trotset
Lydia Trotsetman
Jennifer Unkles
Matt Valliere
John Van deGraaff
Jorden Van Emmerik
Hannah Warren
Marty Wvells
Pete Westover
Kin Wildman-Hanlon
Orlando Wildman-Hanlon
Hannah Wilk
Jonathan and Meg Wright
Anna Yoors
Derek Yorks
Dan Ziomek
Emma Zyskowski
Amherst Cinema

Program Partners, Collaborators and Alliances

Amherst College
Big Brothers Big Sisters
Bramble Hill Farm
Brookfield Farm
Center for Ecotechnology
Coldham & Hartman Architects
The Common School
Cows Lumber
Daily Hampshire Gazette
Durfee Conservatory
Great Falls Discovery Center
Family Outreach Center
Five College Learning in Retirement
Hampshire Bird Club
Hampshire College
Kestrel Trust
Johns Hopkins University
Little Cree Spy Excursions
The Lord Jeffery Inn
Massachusetts Department of
Environmental Protection
Many Hands Farm
Massachusetts Audubon Society

Massachusetts Department of
Conservation and Recreation (DCR)
Massachusetts Environmental
Education Society (MEES)
Mass Walking Tour
Master Gardeners of
Western Massachusetts
Mount Holyoke College
New England Environmental Education
Alliance (NEEEA)
New England Wildflower Society
Northeast Sustainable Energy Association
Robert E. Barrett Fishway, Holyoke
Richard Cronin National Salmon Station
Rushing Rivers Institute
Town of Amherst
The Trustees of Reservations
University of Massachusetts, Amherst
U.S. Fish and Wildlife Service
Valley Environmental
Education Collaborative
Western Mass Saves
Wright Builders

	FY12	FY13
Total volunteers	187	199
Total volunteer hours	3,739	2,999

Biothon

The Hitchcock Center's Biothon happens each year in May when bird migration is at its peak and when many plants are in leaf and bloom. It's when we can expect to see the greatest biodiversity. Teams choose where and when to go out for up to a 24-hour period on Biothon weekend and count species—birds, plants, mammals, reptiles and amphibians, insects, or everything! Biothon is one of Hitchcock's two major fundraising events of the year. Thank you to all of the team "captains" who have made Biothon a resounding success:

2012

Penny Beebe
Jaana Cutson
Nancy Eddy
Janice Gifford
Marie Hess
Martha Hoopes
Katie Koerten

Sarah la Cour
Kate Lamin
Susan Loring-Wells
Jan Ortiz
Lisa Sihvonen-Binder
Susan Smith
David Spector
Ted Watt

Pete Westover
Larry Winship

2013

Danielle Barshak
Elizabeth Farnsworth
Janice Gifford
John Green

Martha Hoopes
John Kowaleski
Kate Lamin
Susan Loring-Wells
David Spector
Ted Watt
Dan Ziomek



EARTH MATTERS

The Hitchcock Center's bi-weekly column in the *Daily Hampshire Gazette* continues to offer readers a wide range of topics on natural history and environmental issues written by numerous authors, including Hitchcock staff, present and former board members, and guest writers.

Hitchcock Center Board member Michael Dover coordinates the column and co-edits with Board member Caroline Hanna, staff member Katie Koerten and Hitchcock photographer Rebecca Reid. We wish to thank all of our authors who contributed columns in FY12 & 13, and our editor at the *Gazette*, Suzanne Wilson.

CONTRIBUTING AUTHORS

David Ahfeld
Kari Blood
Michael Dover
Charley Eiseman
Mark Elbroch
Elizabeth Farnsworth
John Foster
Ken Gooch
Daniel Greenberg
Katie Koerten
Mary Kraus
Joshua Rose
Mark Protti
David Spector
Ginny Sullivan
Ted Watt
Lawrence Winship

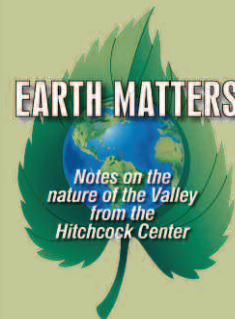



Celebrating 50 Years!

Honoring the Past, Celebrating the Present, Preparing for the Future

Thank you for helping the Hitchcock Center celebrate our 50th anniversary in 2013! Highlights include:

50th Anniversary Open House

On September 15, 2012 over 50 people attended a celebratory open house that included our first ever Naturalist Roadshow, a virtual tour through the U.S. Fish and Wildlife Services's Watershed on Wheels exhibit and birthday cake.

Amherst Area Chamber of Commerce A+ Legacy Award Recipient

The Amherst Chamber of Commerce honored the Hitchcock Center with it's A+ Award. Over 200 people attended this special awards ceremony and dinner held at the Lord Jeffery Inn on October 4, 2012.

50th Anniversary Environmental Film Series

We premiered our first-ever film and speaker series in partnership with Amherst Cinema that featured three distinctive viewpoints on environmental awareness and understanding. Films in the series included: *Microcosmos*, *Dirt! The Movie*, and *The Greening of Southie*. We are grateful to have been joined by local experts including Laurie Sanders, Peter McLean of Brookfield Farm, and Amherst architect Bruce Coldham of Coldham & Hartman Architects. The Lord Jeffery Inn's 30Boltwood offered a prix fixe meal for a fun "Green Date" option.

50th Anniversary Gala

On April 26, 2013, over 200 people attended our 50th Anniversary Gala event held at the Lord Jeffery Inn, in Amherst. Former U.S. Representative John Olver and naturalist John Green were honored with the Heroes for a Healthy Planet Legacy Award, and we premiered our new film *Roots: 50 Years of Growth*. Special thanks to our keynote speaker, Hampshire College President Jonathan Lash for his inspirational words.

50 Places for 50 Years Blog

Hitchcock staff and friends introduced 50 special places to explore for walking, hiking and special landscape features in the Pioneer Valley through weekly blog posts. Published on our website in celebration of 50 years of promoting greater environmental awareness and understanding. To read posts in this series please visit: <http://ow.ly/yufjl>.

Thank you to our blog contributors: Vivienne Carey, Jaana Cutson, Faith Deering, Michael Dover, Elizabeth Farnsworth, John Foster, Arianna Grindrod, Deb Habib, Abbe Hamilton, Julie Johnson, Colleen Kelley, Katie Koerten, Jim Lafley, Micky McKinley, Patty O'Donnell, Jan Ortiz, Jeff Podos, Joshua Rose, Jessica Schultz, Helen Ann Sephton, David Spector, Gini Traub, Jennifer Unkles, and Ted Watt.

50th Anniversary Field Walk Series

Over 120 people participated in our year-round field walk series that brought over six of the Valley's most experienced naturalists together to share their skills, favorite spots and new discoveries.

Heroes for a Healthy Planet Awards

The Hitchcock Center's Heroes for a Healthy Planet award acknowledges a person, family, organization or institution in our community that has made a significant contribution toward increased knowledge, understanding, and stewardship of our local economy.

The Hitchcock Center was pleased to present the 2012 and 2013 Heroes for a Healthy Planet awards to:

2012

The Camera/McKenna Family for Three Generations of Environmental Stewardship

First Generation: Jennie McKenna & Gerry Weiss

Second Generation: Ian & Samantha Camera and Eli McKenna & Kate Filanowski

Third Generation: Jonas Camera & Julian Camera

2013

John W. Olver, former U.S. Representative (Massachusetts 1st District)
Legacy Award for Policy & Advocacy

John Green, Jr., naturalist, photographer, and educator
Legacy Award for Education

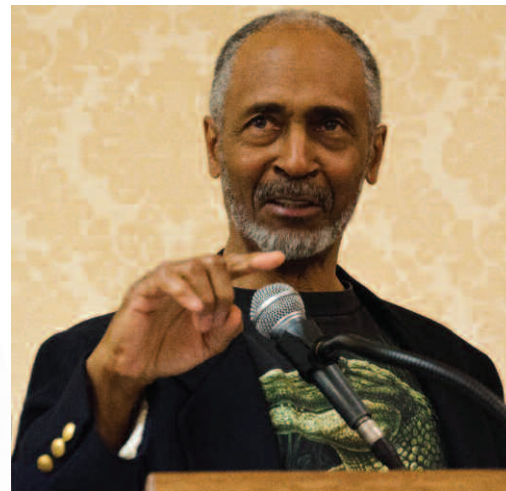

Photos: John Green, Jr. (above); John W. Olver, Julie Johnson, Jaana Cutson (below)

FY12 & FY13 Green Building Project in Review

The Hitchcock Center has been working for five years in extensive planning and preparation toward its future, initiating a new green building project calling for a building that will not only serve as a highly visible model of ecological design, but also will teach people of all ages the science of ecology and the practice of sustainability.

Some milestone achievements include:

FY2012

- Secured new site and partnership with Hampshire College;
- Completed engineering and geotechnical studies of the site;
- Hired fundraising advisor Ellen Leuchs of KirschLeuchs Consulting to plan for a future capital campaign.

FY2013

- Hired design team lead by designLAB architects;
- Received \$30,000 technical assistance grant from the Massachusetts Cultural Facilities Fund to complete the conceptual design;
- Hired Wright Builders as preconstruction advisor;
- Hired Chris Riddle as owner's representative/manager.

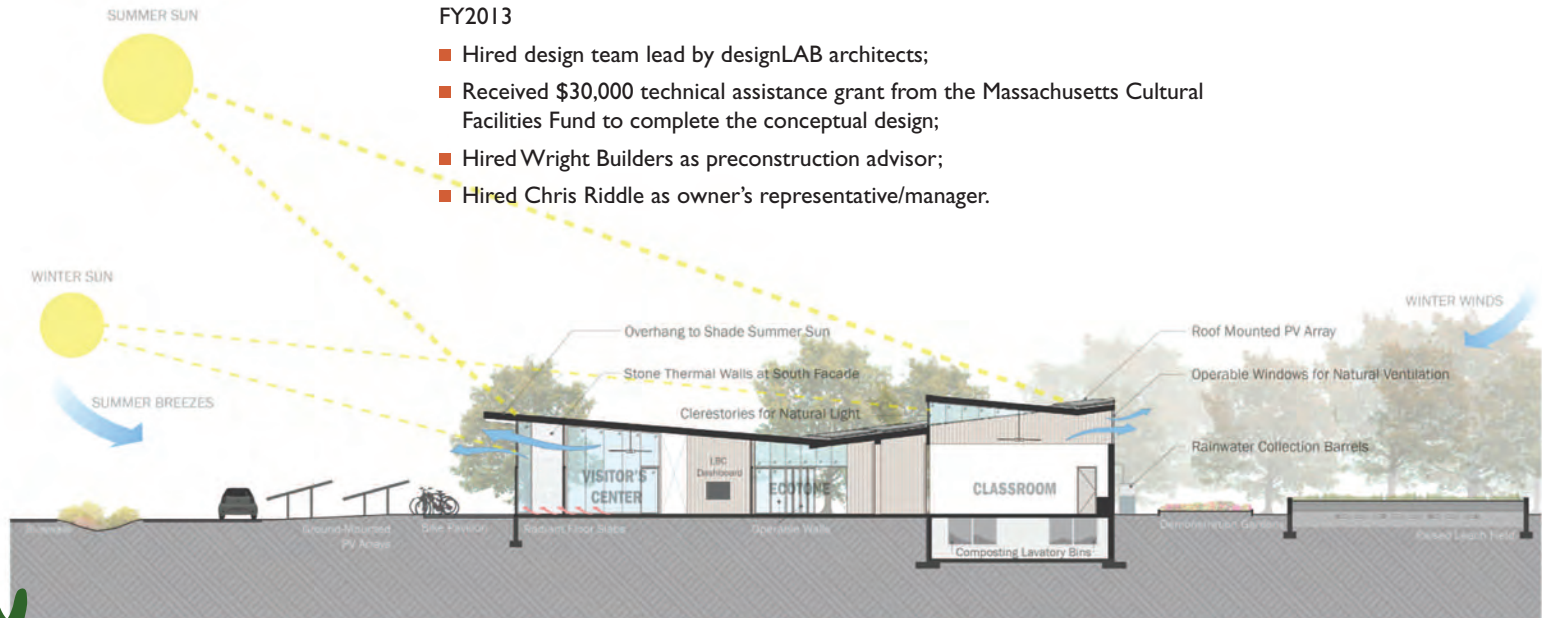



Honoring Dubie's Legacy

The Hitchcock Center for the Environment was founded in 1962 by Ethel Dubois (1906–1987), a retired guidance counselor. Ethel was deeply inspired by the works of Rachel Carson (1907–1964) who is recognized as the founder of the contemporary environmental movement. She bought a farm in Leverett and, with the support of a handful of dedicated volunteers, provided summer camp and nature programs for low-income children living primarily in Holyoke and Springfield. Her goal was to provide these children with opportunities otherwise not available to them: to experience the natural world and to develop a sense of wonder about it.

Initially known as the “Long Plain Nature Center,” the Center’s service region rapidly grew in the ‘60s and ‘70s to include new science and nature programs for schools and communities throughout Hampshire, Hampden and Franklin Counties. It soon outgrew its farm location and in 1976, with the generous support of the town of Amherst, the Center relocated to its present location at the Larch Hill Conservation Area in Amherst.

At about the same time, the Center changed its name to the Hitchcock Center for the Environment in honor of Edward & Orra Hitchcock: Edward, the first Massachusetts state geologist and third president of Amherst College, and Orra, a noted botanical illustrator. Today, the Center remains true to Dubie’s core mission of fostering a greater awareness and understanding of our environment and developing environmentally literate citizens.

Our Supporters

The Hitchcock Center is grateful for the support of the following individuals, businesses and organizations during our fiscal years July 1, 2011–June 30, 2013. Regular annual support ensures that our educational mission and vision remains responsive to the needs of our community.

Scholarship Gifts

Alpine Garden Club 🇺🇸
Jacqi & Scott Ardizzone 🇺🇸
Andrew Bellak & Susan Bain 🇺🇸
Dee Blanton 🇺🇸
Ruth Elcan 🇺🇸
Jordan Fea 🇺🇸
Garden Club of Amherst 🇺🇸
Hampshire Bird Club, Inc. 🇺🇸
Susan Heitker & Mathew Jacobson 🇺🇸
Traci Hess & John Wells 🇺🇸
Sheila Jaswal & Margaret Robertson 🇺🇸
Susan Johnson 🇺🇸
Bernadette & Emlen Jones 🇺🇸
Janice Jorgensen 🇺🇸
Joyce & Bill Mastronianni 🇺🇸
Micky McKinley 🇺🇸
Lenore Miller 🇺🇸
Alicia Morton 🇺🇸
Alexis & Michael Mulvihill 🇺🇸
Joanne Parker & Robert Wilce 🇺🇸
Thomas Pelletier 🇺🇸
Laura Reckford 🇺🇸
South Amherst Congregational Church 🇺🇸
Jennifer & Steve Unkles 🇺🇸

Capital Project Gifts

Anonymous VI 🇺🇸
Anonymous IX 🇺🇸
Anonymous X 🇺🇸
Harvey Allen 🇺🇸
Andrew Bellak & Susan Bain 🇺🇸
Casey Clark 🇺🇸
Jaana Cutson & Paul Rothenberg 🇺🇸
Michael Dover & Rebecca Reid 🇺🇸
Nancy Eddy 🇺🇸
Charles & Susan Haight 🇺🇸

Caroline & Howard Hanna 🇺🇸
Sheri Heitker & Mark Dixon 🇺🇸
Marie Hess 🇺🇸
Julie Johnson 🇺🇸
Sarah & Niels la Cour 🇺🇸
Ann Romberger & Martha Ackmann 🇺🇸
Michael G. Schwartz 🇺🇸
Gordon Schimmel 🇺🇸
Patricia Finley 🇺🇸
Pamela Stone & James Humphrey 🇺🇸
Dan & Emily Ziomek 🇺🇸

Foundations, Nonprofits, Public Agencies

Anonymous VI 🇺🇸
Center for Early Education & Care 🇺🇸
The Common School 🇺🇸
Community Foundation of Western Massachusetts 🇺🇸
Community Foundation of Tampa Bay 🇺🇸
Evergreen Foundation 🇺🇸
Hampshire Bird Club 🇺🇸
Institute for Training & Development 🇺🇸
The Kendeda Fund 🇺🇸
Learning in Retirement 🇺🇸
Northfield Sitting Group 🇺🇸
Sunnyside Child Care Center 🇺🇸
Trustees of Hampshire College 🇺🇸
The Trustees of Reservations 🇺🇸
United Way of Central and Northeastern Connecticut 🇺🇸
United Way of Hampshire County 🇺🇸
United Way of Pioneer Valley 🇺🇸

Bequests

Eva Schiffer 🇺🇸
Dorothy Swanson 🇺🇸

Annual Fund & Membership Gifts: \$9,999–\$2,000

Anonymous IX 🇺🇸
Anonymous X 🇺🇸
Anonymous XI 🇺🇸
Rema Boscov 🇺🇸
Morgan Brill 🇺🇸
Jaana Cutson & Paul Rothenberg 🇺🇸
Patricia Finley 🇺🇸
Janice Gifford 🇺🇸
Bob Saul & Katie Fretwell 🇺🇸
Pamela Stone & James Humphrey 🇺🇸
Neal Abraham & Donna Wiley 🇺🇸

Annual Fund & Membership Gifts: \$1,999–\$1,000

Anonymous III 🇺🇸
Anonymous VI 🇺🇸
Harvey Allen 🇺🇸
Dorothy & Ramon Barnes 🇺🇸
Andrew Bellak & Susan Bain 🇺🇸
Big Sur River Inn 🇺🇸
Margaret Bullitt-Jonas & Robert Jonas 🇺🇸
Vivienne Carey & Roger Webb 🇺🇸
Sabina & Norman Cournoyer 🇺🇸
Steven Gilbert 🇺🇸
Julie & David Gross 🇺🇸
Gordon Hall 🇺🇸
Katherine Hammond 🇺🇸
Bill & Vickie Hart 🇺🇸
Mary Hocken & Ann Kearns 🇺🇸
Jeff & Alex Lefebvre 🇺🇸
Tom Ewing & Marilyn London-Ewing 🇺🇸
Charles & Polly Longworth 🇺🇸
Alice Mertz 🇺🇸
Susan Morello & Nathan Salwen 🇺🇸
Dr. Victoria Pillard 🇺🇸
Michael G. Schwartz 🇺🇸
Mary Taft & Leslie Smith 🇺🇸
Lawrence Winship & Ellen Donkin 🇺🇸

Annual Fund & Membership Gifts: \$999–\$500

Janice & Louis Albano 🇺🇸
Anne Appleby 🇺🇸
Helga Beatty 🇺🇸
Penny Beebe 🇺🇸
Elaine Beilin & Robert H. Brown 🇺🇸
Catherine Bickford & Bob Cann 🇺🇸
James D. Brassord 🇺🇸
Marybeth Bridgegam 🇺🇸
Andrew Brill 🇺🇸
Anne Cann 🇺🇸
Susan Heitker & Mathew Jacobson 🇺🇸
Lynn & Jean Miller 🇺🇸
John & Rose Olver 🇺🇸
Rebecca Reid & Michael Dover 🇺🇸
Shari Roessler 🇺🇸
Ann Romberger & Martha Ackmann 🇺🇸
Nathan & Lenore Rothenberg 🇺🇸
Jan & Robin Dizard 🇺🇸
Nancy Eddy 🇺🇸
Aila Erman 🇺🇸
Judith Espinola & Susan Perry 🇺🇸
Timothy Farnham & Ellen Alvord 🇺🇸
Elizabeth Farnsworth & Aaron Ellison 🇺🇸
Marie Hess 🇺🇸
John Kowaleski & Erin Baker 🇺🇸
Jim Lafley & Sharon Wood 🇺🇸
Nancy MacMillan Hoopes & Alison Laura Pachynski 🇺🇸
Russ & Jan Odwazny 🇺🇸
Lynn Pasquerella & John Kuchle 🇺🇸
Harriet & Alexander Pollatsek 🇺🇸
Mr. Richard Proctor 🇺🇸
Peter Snedecor & Anne Scarff 🇺🇸
David Spector & Magda Bechar 🇺🇸
Alice Swift 🇺🇸

Annual Fund & Membership Gifts: \$499–\$250

Danielle Barshak & Oran Kaufman 🇺🇸
Peter & Ellen Berek 🇺🇸
Jane & Steven Brown 🇺🇸
Samuel & Karen Butcher 🇺🇸
Casey Clark 🇺🇸
Ruth Elcan 🇺🇸
Susan & Wayne Emerson 🇺🇸
Rachel Fink & Tom Dennis 🇺🇸
Susan & Michael Frazier 🇺🇸
Judy Gatland & Jon Lord 🇺🇸
Nancy Goodman 🇺🇸
Michele Granda 🇺🇸
Caroline & Howard Hanna 🇺🇸

Martha & Robert Hanrott 🇺🇸
Bruce Hart & Ilene Goldstein 🇺🇸
Aaron Hayden 🇺🇸
Sara Hills 🇺🇸
Doris Holden 🇺🇸
Justine G. & John C. Holdsworth 🇺🇸
Rachel Hoopes 🇺🇸
George Howard & Barbara Davis 🇺🇸
Ruthie & Michael Ireland 🇺🇸
Peter Jessop & Maureen Humpage 🇺🇸
Julie M. Johnson 🇺🇸
Julane Knobil 🇺🇸
Don Kroodsma 🇺🇸
Boyd & Janice Kynard 🇺🇸
Sarah & Niels la Cour 🇺🇸
Joan & Ken Langley 🇺🇸
Rich & Cathy Lawlor 🇺🇸
Ellen Leuchs 🇺🇸
Caitlin Lippincott 🇺🇸
George Loring 🇺🇸
Susan Loring-Wells & Marty Wells 🇺🇸
Elizabeth Loughran 🇺🇸
Arthur & Elaine Mange 🇺🇸
Michelle Markley 🇺🇸
Sarah & Douglas Marshall 🇺🇸
Jennifer McKenna & Gerald Weiss 🇺🇸
John & Paula Moore 🇺🇸
Janet & Carlos Ortiz 🇺🇸
Thomas Pelletier 🇺🇸
Lorna & Dale Peterson 🇺🇸
Kinga Pluta & Michael Rosenblum 🇺🇸
Mark Protti & Michele Sedor 🇺🇸
Joshua & Airlie Rose 🇺🇸
Laurel Savoy 🇺🇸
Helen Ann & Graeme Sephton 🇺🇸
Lisa & Paul Sihvonen-Binder 🇺🇸
Susan M. Smith 🇺🇸
Michele & Blake Spirkko 🇺🇸
Dr. Amy Springer & Aaron Hayden 🇺🇸
Jean & Cassie Springer Toulouse 🇺🇸
Gretchen & Lewis Stone 🇺🇸
Scott Turner & Valerie Miller 🇺🇸
Richard & Mary Thayer 🇺🇸
Jacqueline & Robert Tuthill 🇺🇸
John Van de Graaff & Marylee Bomboy 🇺🇸
Lydia & Russ Vernon-Jones 🇺🇸
Stephen Warner & Sharon Carty 🇺🇸
Chris Warren 🇺🇸
Robert Wilce & Joanne Parker 🇺🇸
Nancy & Don Wise 🇺🇸
Anne Zinsser 🇺🇸

Annual Fund & Membership Gifts: \$249-\$100

Anonymous IV
James & Marjorie Abel
Doug Adler
Jon & Sarah Adolph
Sue Alexander
Alice Allen
Craig & Emily Allen
Tom & Sandra Alworth
Michele Cooke-Andresen
& Gavin Andresen
David Arfa & Kim Erslev
John & Elizabeth Armstrong
Mr. & Mrs. James Babson
Joanna & Clay Ballantine
Peter & Anne Barry
Peter & Sandra Beak
Ralph & Mildred Beals
Edward & Emily Belt
Chris Benfey & Mickey Rathbun
Bill Benner & Joe Wicinski
Richard Berman & Elizabeth Aries
Lisa Maria Bertoldi & William B. Sayre
Katherine Binder
Joseph & Jane Bodin
Karen Bourque & Robert Horton
Dennis A. Bowen & Elizabeth Pyle
Leslie & Dwayne Breger
Ginny Brewer & Betsy Howlett
Lee & Will Bridegam
Renaë Brodie & Mwangi Wa Githinji
Barry & Judy Brooks
Joanna Brown
Lindsey Britt
Jesse Brownback III
Merle S. Bruno & Peter Vincent
Nancy & Bill Buchanan
Elisa K. Campbell
Nancy Campbell
Karen Chauvin Katsanos
& Richard Katsanos
Joanne & Sean Cleary
George & Cheryl Cobb
Taryn Collins
Beverly Cowdrick
Brad Crenshaw & Deborah Gorlin
Craig B. Cutson
Marvin & Sonya Cutson
Charlene D'Avanzo
Corinne Demas
Daniel & Anna Jean Dindal
Sarah Dixwell Brown

Paul Dobosh
Sarah C. Doering
Diane & Paul Doherty
Carl & Juliana Dupre
Sara Eddy & Ken Kleinman
Jan S. Eidelson
Dawn Ellenwood & Peter Ferguson
Seymour Epstein
Ronna Erickson
Adrian Fabos
Jackie & Carl Fiocchi
Dorothy & Hugh Friel
Helen Gibson & James Uguccioni
Bill & Connie Gillen
Robert Graham & Judi Pierce
Priscilla & Fred Greeley
Anita & Thayer Greene
Barbara Griffith
Bob & Ann Grose
Nora Hanke
Mary Hankowski
Holly Hanson
Davis Hawkowl
Julie H. Hawkowl
Bob Hawley & Mary McCarthy
Nancy Hazard
Dave & Marty Healy
Frank Heitker
Sheri Heitker & Mark Dixon
John & Priscilla Hellweg
Peter & Peggy Hepler
Traci Hess & John Wells
Kenneth & Lauren Holt
David & Katherine Hoopes
Matthew Hoopes
John Hoops
Susan Howe
Mary Hulbert & Anne Morehouse
Joan Marie Jackson & Mitchell Speight
Betsey Johnson
Bernadette & Emlen Jones
Aaron & Abigail Julien
Colleen Kelley & David Perlmutter
George Karras & Jeanne Esposito
Christopher & Mary Kiely
Jan Klausner-Wise
Robin Kline
Kristine Koczajowski
Richard & Rosemary Kofler
Mary Kohler
Alan & Jo-Ann Konieczny
Mary Kraus & John Fabel
Rhett & Susan Krause
Bonita & Robert Krotkov
Susan Landau & Neil Immerman
Libby & Daniel Lass
Tanya Leise & Andrew Cohen
Stacey Lennard & Stephen Saxenian
David Levit & Ruth Kane-Levit
Barry Levy
Peter & Maija Lilly
Christine Lindeman
Paul & Marcelle Lipke
Bridgit & Jerry Litchfield
Anne Lombard
Samuel Lovejoy
Jane Luff
James Macallister
Lisa MacCullough & Aaron Somoza
Eleanor Manire Gatti & Frank Gatti
Carol Mardeusz
Nora & Tony Maroulis
Craig Martin & Lynmarie Thompson
Carolyn & Richard Mathews
Kristin Mattocks
Richard McCarthy
Gale, Thomas & William McClung
Emily & John McDermott
Dymphna McWilliams & Todd Walker
Joyce Merriam
Will Millard
Rebecca Miller & Tom Randall
Thomas Millette & Susan Alston
Susan P. Millinger
Charles & Kay Moran
Monica Moran & Bill Wehrli
John Morgan & Pamela Wilkinson
Alexis & Michael Mulvihill
John & Marlene Musante
James A. & Suzanne F. Muspratt
Edith Nye MacMullen
Patty O'Donnell & Rick Gerstein
Debra Ogera & George Kohout
Susan Paulson
David Peake-Jones
Susan Perry
Mrs. Mary Catherine Phinney
Lisa Plantefabar & Steve Fischel
Deb Porter
Elizabeth Preston & Cindy White
Elaine Puleo & John Buonaccossi
Patricia Ramsey
Jane Rathbun
Nancy & David Ratner

Clifton & Arleen Read
Susan & Steve Rice
Margaret & Bob Riddle
Anne Robbins & Gretchen Dock
John & Lucy Robinson
Robert & Betty Romer
Steve Roof & Maddalena Coppi
Kenneth Rosenthal
Britt & Colin Ruhe
David Rundle & Catherine Huntley
Douglas & Sara Ruopp
Carlos & Mary Santiago
Jim & Nina Scott
Karen & Dennis Searcy
Seth & Bethany Seeger
Margarita Shannon & Nina Dabek
Mark Siddall
Will & Liz Sillin
Karen Skolfield & Dennis Goeckel
Judith Smith & Kenyon Fairey
Judith Souweine
Diana & Otto Stein
Randi Stein
Morton & Helen Sternheim
Sandra Surner
Hariharan Swaminathan
Ken & Kitty Talon
Ralph & Vicki Tate
Lisa Terrizzi & Bruce Bagdasarian
Marylou Theilman
Sarah Todd
Nancy & Philip Torrey
Jennifer & Steve Unkles
Katharine & Tyll van Geel
Victoria Vest
Pamela C. Victor
F. Peter Von Ziegessar & Hallie Lee
Tom & Christine Warger
Beverly Weeks
Bill Wehrli
Kathy & Phil Weilerstein
Benjamin Weiner
Elizabeth Welsh & Amy Brodigan
Pete Westover
Josef Wille & Suzanne Parker
Beth Willson & Fred Steinberg
Brayton & Mary Alice Wilson
Lucy Wilson Benson
Bob & Jan Winston

Jonathan Woodbridge & Diane Steingart
Kathleen Woods Masalski
& William Masalski
Andrea Wright & Peggy Anderson
Jonathan Wright
& Margaret Kelsey Wright
Erika Zekos & Derek Noble
Linda Ziegenbien
Erik Zimmerman & Maureen Millea
Daniel & Emily Ziomek
David & Maria Ziomek
Sue & Mike Zlogar

Annual Fund & Membership Gifts: \$99 and under

Anonymous I
Anonymous II
Anonymous V
Anonymous VII
Anonymous VIII
Robert & Frances Abrams
Inge & Robert Ackermann
Lisa & Thomas Aiken
Douglas Albertson
Anne Alexander
Charles & Gina Allen
Ann & Arnold Alper
Mike & Barbara April
Jacqi & Scott Ardizzone
Caroline & Gordon Arnold
Jennifer Atkins
Doris Atkinson
Marguerit T. Atkinson
Stephen & Katherine Atkinson
Patricia & John Auth
James & Judith Averill
James Ayres & Keira Durrett
Andrea & Jacob Ayyazian
Nancy Bair
Stephen Baker & Sharon Dombeck
Lois Barber
Adelia & Fred Bardwell
Audrey Barker-Plotkin
Sean Barry
Christine Barsby
Mira Bartok
Rick Baruc & Deborah Habib
Karen Bates & Summyr Kerin
Andrea Battle & Whitney Battle-Baptiste
Glenn Benson
Kathie Benson
Patricia Benson
Michael & Tina Berins

Paul & Yvonne Berman 🇺🇸
 Margaret & Al Bernstein 🇺🇸
 Lisa Berry 🇺🇸
 Carolyn Biagi 🇺🇸
 Anthony Bishop & Seunghee Cha 🇺🇸
 Norm Bland 🇺🇸
 Dee Blanton 🇺🇸
 Peter Blier & Patty Blauner 🇺🇸
 Emily Bloch 🇺🇸
 Alan Bloomgarden & Kathleen Bredin 🇺🇸
 Matthew Blumenfeld
 & Claudia Canale-Parola 🇺🇸
 Mary Bohan 🇺🇸
 James & Paris Boice 🇺🇸
 Carol Booth 🇺🇸
 Kiqe Bosch 🇺🇸
 James & Cynthia Boscov 🇺🇸
 Beatrice Botch 🇺🇸
 Steven Botkin & Joan Levy Family 🇺🇸
 Elaine Bowditch 🇺🇸
 James Boyce & Betsy Hartman 🇺🇸
 Denise Boyd & Paul Danielovich 🇺🇸
 Audrey J. Bozzo 🇺🇸
 Christine Brestrup 🇺🇸
 Joann Breuer 🇺🇸
 Gerald Bridwell 🇺🇸
 Charlotte Briggs & Deslonde Parkinson 🇺🇸
 Shirley Brodigan 🇺🇸
 Catherine & Robert Brooks 🇺🇸
 Steven Brown & Lisa Oram 🇺🇸
 Cynthia & Jerry Brubaker 🇺🇸
 Jill Bubier & George Stone 🇺🇸
 Nancy Buffone 🇺🇸
 Margaret Burggren 🇺🇸
 Elizabeth Cahn 🇺🇸
 Sam & Ian Camera 🇺🇸
 Helen Cardinaux 🇺🇸
 Arlene Carmichael 🇺🇸
 Allan & Barbara Carpenter 🇺🇸
 Marria & Lex Carrington 🇺🇸
 Elaine Cat & Richard Loomis 🇺🇸
 Wendy Catlin 🇺🇸
 Laura Chalk 🇺🇸
 Maria Chao 🇺🇸
 Annie Cheatham & Ann Gibson 🇺🇸
 David Chernock 🇺🇸
 Jon Child & Liz Rosenberg 🇺🇸
 Caterina Cianciulli 🇺🇸
 Theodore & Alice Clark 🇺🇸
 Jeanne & John Clayton 🇺🇸
 John Clayton & Sharon Dunn 🇺🇸

Carl Clements & Amanda Barrow 🇺🇸
 Cheri Cluff 🇺🇸
 Cathy & Joe Cohen 🇺🇸
 Ann Colacchi 🇺🇸
 Carolyn Collette 🇺🇸
 Roger & Shirley Conant 🇺🇸
 Rachel Conrad & Tom Rooney 🇺🇸
 Sara B. Cooper & Jon Chamutka 🇺🇸
 Marion Copeland & Kathryn Holmes 🇺🇸
 Lorraine Cordeiro 🇺🇸
 Suzanne & Wayne Cordes 🇺🇸
 Janet Cornell 🇺🇸
 Mary & Matt Cornell 🇺🇸
 Catherine Corson 🇺🇸
 Brian Costello 🇺🇸
 Artelia Court 🇺🇸
 Sally Crawford & Jane Porter 🇺🇸
 Elizabeth Crone 🇺🇸
 Jennifer Culbreth & Tara Loomis 🇺🇸
 Merrilyn Cushing 🇺🇸
 Tanya M. Cushman 🇺🇸
 Marvin Daehler 🇺🇸
 Grace & Edward Dane 🇺🇸
 Marlaine & Richard Darfler 🇺🇸
 Nicholas Darnton & Laura Cadonati 🇺🇸
 Donald David 🇺🇸
 Judith Davidov 🇺🇸
 Joan Davis 🇺🇸
 Kathleen Davis 🇺🇸
 Marcia Davis 🇺🇸
 Kristin Deboer & Thomas Hartman 🇺🇸
 Andres del Campo Garcia 🇺🇸
 Isabella Dellolio 🇺🇸
 Andree Demay & Sarah Morin 🇺🇸
 Tom & Sheila DeSelling 🇺🇸
 Carol Dick 🇺🇸
 Victoria Dickson & David Ahfeld 🇺🇸
 Richard Dirks 🇺🇸
 Gary & Linda Donnelly 🇺🇸
 Robert Duby 🇺🇸
 Sally Dumont 🇺🇸
 Steven Dunn & Jessica Plaut 🇺🇸
 Mary & David Dunn 🇺🇸
 Alan Durflee 🇺🇸
 Carolyn Eckert 🇺🇸
 Chuck & Cheryl Edgerly 🇺🇸
 Andrea Egitto 🇺🇸
 Larry & Tammy Ely 🇺🇸
 Paul & Deborah Engel 🇺🇸
 Amy Erard 🇺🇸
 Arthur & Barbara Eve 🇺🇸
 Veronica & Peter Everett 🇺🇸
 Kent Faerber 🇺🇸

Frances Fairchild 🇺🇸
 Andy & Sally Fairfield 🇺🇸
 Molly Falsetti-Yu 🇺🇸
 Ralph & Linda Faulkingham 🇺🇸
 Ruth Feldberg 🇺🇸
 Chris & Todd Felton 🇺🇸
 Leslie Fields & Sven Aas 🇺🇸
 Barbara Fischer 🇺🇸
 Laura Fitch & Lyons Witten 🇺🇸
 Kay Fite 🇺🇸
 Gloria Flaim & John McCann 🇺🇸
 Paul & Susan Fleischman 🇺🇸
 Melanie & Gordon Fletcher-Howell 🇺🇸
 Kyle Forbes Bissell & Christa Ann Drew 🇺🇸
 Barbara C. Ford 🇺🇸
 Robin Fordham & William Miller 🇺🇸
 John & Georgiana Foster 🇺🇸
 Barbara Francis & Al Woodhull 🇺🇸
 Jeanne Friedman & Carol-Ann Smalley 🇺🇸
 Barbara Fukushima & Peter Stoneham 🇺🇸
 John & Carol Gabranski 🇺🇸
 Becky Gahan 🇺🇸
 Jean & John Galbraith 🇺🇸
 Lissa Ganter 🇺🇸
 Tom Gardner & Karen Levine 🇺🇸
 Janet Gary & Gregory Kerstetter 🇺🇸
 Michael Giampietro 🇺🇸
 Elizabeth Giannini & Jeffrey McCullough 🇺🇸
 Margot Gifford 🇺🇸
 Cynthia Gill 🇺🇸
 Penny Gill 🇺🇸
 Elizabeth Gillen 🇺🇸
 Peggy Gillespie 🇺🇸
 Bob Gilmore & Amy Burnside 🇺🇸
 Laura & Julien Ginsberg-Peltz 🇺🇸
 Melissa Giraud 🇺🇸
 David Glassberg 🇺🇸
 David & Anne Goehring 🇺🇸
 Richard & Elizabeth Goeselt 🇺🇸
 Nancy & Craig Goff 🇺🇸
 Goldbaum Spitz Family 🇺🇸
 Linda & Graham Gordon 🇺🇸
 Kathleen Gormally 🇺🇸
 Dave Gott 🇺🇸
 Harold & Sandra Gould 🇺🇸
 Eliza Gouverneur & Richard Cohen 🇺🇸
 Adrian Grace & Derek Fowles 🇺🇸
 Gerald & Judith Grant 🇺🇸
 John Green 🇺🇸
 Roderic & Ann Greene 🇺🇸
 Viveca Greene & Chris Perry 🇺🇸
 Rachel Greenwood 🇺🇸
 Sara Greisemer 🇺🇸

Carol Grey & Jeff Lee 🇺🇸
 Mary Ann Grim 🇺🇸
 James Grogan 🇺🇸
 Jean Grossholtz 🇺🇸
 Louise & Ron Grosslein 🇺🇸
 Rebecca Guay & Matthew Mitchell 🇺🇸
 June Guild & Joel Halpern 🇺🇸
 Elizabeth & John Gummere 🇺🇸
 Judy & Larry Gutlerner 🇺🇸
 Peter Haas & Julie Zuckman 🇺🇸
 Mara & Harry Hahn 🇺🇸
 Molly Hale 🇺🇸
 Sylvia Halkin 🇺🇸
 Lee Hall 🇺🇸
 Mary Hall 🇺🇸
 Shirley Hammerschmidt 🇺🇸
 Thea Hardigg 🇺🇸
 Louise Harper 🇺🇸
 Lesley Harrington 🇺🇸
 Heather Hart 🇺🇸
 Sarah Hart Agudelo 🇺🇸
 Kyla & Keith Hastie 🇺🇸
 Jennifer Haugsjaahabink 🇺🇸
 Lissa Ganter 🇺🇸
 Ruth Hazzard & Claude Tellier 🇺🇸
 Theresa Heath 🇺🇸
 Steven & Maria Heim 🇺🇸
 Marnie Henneman 🇺🇸
 Dara Herman-Zierlein & Peter Zierlein 🇺🇸
 Gene & Jeffrey Hersh 🇺🇸
 James & Jacquelyn Hickey 🇺🇸
 Elizabeth Higgins & Douglas King 🇺🇸
 Barbara Hoadley 🇺🇸
 Anne & Chris Hoffmann 🇺🇸
 William Holladay & Patricia Appelbaum 🇺🇸
 Patricia Holland 🇺🇸
 Ann Hondrogen 🇺🇸
 Rhoda Honigberg 🇺🇸
 Bethanie Hooker & Timothy Binzen 🇺🇸
 Helen Hoopes 🇺🇸
 Heather & John Hornik 🇺🇸
 Margaret Horsnell 🇺🇸
 Janet Howard 🇺🇸
 Frieda Howards 🇺🇸
 Merle & Billie Marie Howes 🇺🇸
 Betsy Howlett 🇺🇸
 Mary Hoyer 🇺🇸
 Paul Ita & Katherine Glatter 🇺🇸
 Scott Jackson & Chris Sarfaty 🇺🇸
 Paul Jacobs & Jennifer Swender 🇺🇸
 Shelia Jaswal & Margaret Robertson 🇺🇸
 Jean Jeffries 🇺🇸
 Kent & Jeanne Jenkins 🇺🇸
 Amy Olney Johnson 🇺🇸

Kyle Johnson 🇺🇸
 Leslie Johnson & John Tobiason 🇺🇸
 Mark Johnson 🇺🇸
 Nancy & Russell Johnson 🇺🇸
 Mary Jones 🇺🇸
 Teresa Jones & Dewitt Thompson 🇺🇸
 Janice Jorgensen 🇺🇸
 Dan Kaden 🇺🇸
 Laurie Kamins 🇺🇸
 Keith & Julie Kaneta 🇺🇸
 Jacquelyn & Eugene Kang 🇺🇸
 Gina Kaufman 🇺🇸
 Jill Kaufman & Avraham Harris 🇺🇸
 Patrick Kelly & Cynthia Spell 🇺🇸
 Diane Kelton 🇺🇸
 Marian Kent & Aaron Meuse 🇺🇸
 Judith Kenyo 🇺🇸
 Jennifer Killara Burn 🇺🇸
 Lydia King 🇺🇸
 Jonathan Klate & Carlotta Willis 🇺🇸
 Alisa Klatte 🇺🇸
 Anna Klein 🇺🇸
 Dianne Klenotic 🇺🇸
 Lu Knox 🇺🇸
 Katie Koerten & Matt Valliere 🇺🇸
 Wendy Kohler 🇺🇸
 Brian & Jennifer Konieczny 🇺🇸
 Sujata & Jeffrey Konowitz 🇺🇸
 Sherry Krause 🇺🇸
 Melissa Kroodsma 🇺🇸
 Sonia Krotkov & Scott Norris 🇺🇸
 Arn Krugman 🇺🇸
 Mohini & Jason Kulp 🇺🇸
 Anthony Kurpaska
 & Katherine Robinson Kurpaska 🇺🇸
 Anne Kusiak 🇺🇸
 Kathryn Lachman & Jesse Ferris 🇺🇸
 Phyllis Ladd 🇺🇸
 Catherine Lafleur 🇺🇸
 Seal LaMadeleine 🇺🇸
 Lyssia Lamb-MacDonald 🇺🇸
 Kevin Landau & Jessica Wolff 🇺🇸
 Richard & Vera Lane 🇺🇸
 Henry Lappen 🇺🇸
 Susan Lavallee 🇺🇸
 Winston & Margaret Lavallee 🇺🇸
 Sara Lawrence 🇺🇸
 Carole Learned-Miller 🇺🇸
 Mathew Lebowitz 🇺🇸
 Jumea Lee 🇺🇸
 Amity & Scott Lee-Bradley 🇺🇸
 Donald & Cindy Legare 🇺🇸
 Phyllis Lehrer 🇺🇸

Denise Lello & L. David Smith 🇺🇸
 Vikki Lenhart 🇺🇸
 Kristin & Simon Leutz 🇺🇸
 Susan Lewandowski 🇺🇸
 C. Renee Lieberman-Bachman 🇺🇸
 Janet Lieson 🇺🇸
 Kirsten Lindblom & Jay Baudermann 🇺🇸
 Ken & Sylvia Lindsay 🇺🇸
 Jessica & Oliver Lindsey 🇺🇸
 Paul Lipman & Dulcie Trowbridge 🇺🇸
 Richard Little 🇺🇸
 Farnsworth Lobenstine & Amy Ben-Ezra 🇺🇸
 Deborah Long 🇺🇸
 Alicia & Celso Lopez 🇺🇸
 Shelly Love & Brian Franczak 🇺🇸
 Susan Lowenstein 🇺🇸
 Robert Ludwig 🇺🇸
 Kathleen Lugosch 🇺🇸
 Carole Lynch 🇺🇸
 Robert & Patricia Lynch 🇺🇸
 Jesse Lytle 🇺🇸
 Robert & Karen Mack 🇺🇸
 Laura & Samuel Macleod 🇺🇸
 Marjorie Macleod & James Bonham 🇺🇸
 Cynthia Magelinski 🇺🇸
 Jessie Mager 🇺🇸
 Marianne Mahoney 🇺🇸
 Owen Maloney 🇺🇸
 John & Cathy Manly 🇺🇸
 Joel Martin 🇺🇸
 Anna Martini & Maria Kopicki 🇺🇸
 Karl Martini & Cynthia Weigel 🇺🇸
 Dawn Marvin Ward & Steve Ward 🇺🇸
 Michael Mascis & Noreen Cmar Mascis 🇺🇸
 Peter May & Eleanor Gellman 🇺🇸
 Daniel & Noreen McCarthy 🇺🇸
 Linda McCarthy 🇺🇸
 Peg & Paul McDaniel 🇺🇸
 John & Allison Bleyler McDonald 🇺🇸
 Pat McGiffin 🇺🇸
 Susan McGinn & Jay Mankita 🇺🇸
 Catherine McGraw & Robert Spence 🇺🇸
 Sarah McKee 🇺🇸
 Daniel & Norma McKenna 🇺🇸
 Patricia McManamy 🇺🇸
 Becky & Roy McNiven 🇺🇸
 Malcolm Meltzer 🇺🇸
 Marcia Merithew & Julie Kosson 🇺🇸
 Karen Merrill & Martha Umphrey 🇺🇸
 Victoria Merson Pickwick 🇺🇸
 Mary & Frank Meyers 🇺🇸
 Lenore Miller 🇺🇸

William Miller 🇺🇸
 Joya Misra & David Mednicoff 🇺🇸
 Yuko Mizutani 🇺🇸
 Kyounghee & Kyoung Moon 🇺🇸
 Gillian Morbey 🇺🇸
 Alicia Morton 🇺🇸
 John Moss 🇺🇸
 Brenda Mueller-Lamore & Ethan Lamore 🇺🇸
 David & Betsy Mullins 🇺🇸
 John & Alice Mullins 🇺🇸
 Cam & David Munska 🇺🇸
 Diane & Laurence Murch 🇺🇸
 Ralph & K.C. Murphy 🇺🇸
 Ladimer & Anna Nagurney 🇺🇸
 Katherine Naughton 🇺🇸
 Suzanne Newby Estes 🇺🇸
 Louise Nicholas 🇺🇸
 Kathryn Nobrega & James Janisch 🇺🇸
 John Nove 🇺🇸
 Anne Novosel-Mileski & James Mileski 🇺🇸
 Melissa O'Brien & Oliver Doisneau 🇺🇸
 Joanna Olin 🇺🇸
 Gary Orliwsky 🇺🇸
 Isolda Ortega-Bustamante & Jaime Davila 🇺🇸
 Carol Owen & Michael Posner 🇺🇸
 Frank Ozereko 🇺🇸
 & Francine Trearchis Ozereko 🇺🇸
 Norma Packard 🇺🇸
 Nancy Paglia 🇺🇸
 Sandy Pallotta 🇺🇸
 Elisabeth Papademetriou 🇺🇸
 Mark & Sandra Parent 🇺🇸
 Pam Parkhurst & Thomas N. Harris 🇺🇸
 Sheila Patek 🇺🇸
 Laura & Martha Patrick 🇺🇸
 Mimi & Chip Patten 🇺🇸
 Marilyn Patti 🇺🇸
 Robert Peck 🇺🇸
 John & Jane Pemberton 🇺🇸
 Judith Perera 🇺🇸
 Anne Perkins 🇺🇸
 Christina W. Platt 🇺🇸
 Daniel Pope 🇺🇸
 Tish Poulter 🇺🇸
 Sally Powell 🇺🇸
 Laurie Priest 🇺🇸
 Scott Przystas & Skye Belle 🇺🇸
 Shannon Quinn 🇺🇸
 Joseph & Elizabeth Rae 🇺🇸
 Karen Raih & Jenn Roberts 🇺🇸
 Sheila Rainford 🇺🇸
 Heather Reed 🇺🇸
 Luisa Reichenheim 🇺🇸

Katharine Reichert & Margaret Frerichs 🇺🇸
 Lola Reid 🇺🇸
 Louise & Frank Reilly 🇺🇸
 Deborah Reiter 🇺🇸
 John L. & Marilyn H. Reynolds 🇺🇸
 Heidi Rheingold-Bonn & Gregg Bonn 🇺🇸
 Julie Rice DeWalt 🇺🇸
 Donna Rickerby & Karen McKee 🇺🇸
 Pamela & Bart Rietkerk 🇺🇸
 Cynthia Roberts & Deborah Penzias 🇺🇸
 Lou Roberts 🇺🇸
 Michael Robinson 🇺🇸
 William & Theresa Rock 🇺🇸
 Vincent Romano & Claire Cocco-Romano 🇺🇸
 Andra Rose & Joshua Goldstein 🇺🇸
 Fred Rose 🇺🇸
 Joshua Rosenthal & Amber Douglas 🇺🇸
 Michael & Peg Ross 🇺🇸
 Sheldon Ross & Diana Peters-Ross 🇺🇸
 Deborah & Marc Rothenberg 🇺🇸
 Rona Rothenberg & Don Benander 🇺🇸
 Margery Roy 🇺🇸
 Elissa & Bernie Rubinstein 🇺🇸
 Jennifer Ryan 🇺🇸
 Brian Sabel & Karen Lederer 🇺🇸
 Ana Marie Salicioni 🇺🇸
 Teresa & Steven Sandler 🇺🇸
 Ilana & William Schmitt 🇺🇸
 David Schneider & Klara Moricz 🇺🇸
 Jessica Schultz 🇺🇸
 Ariella Schwell & Roger Magnus 🇺🇸
 Cara Segal 🇺🇸
 Linda Seidman 🇺🇸
 Camil Shaheen 🇺🇸
 William & Noel Shamleffer 🇺🇸
 Miranda & John Shannon 🇺🇸
 Jeffrey Sharp & Rebecca Matthews 🇺🇸
 Martha Shea 🇺🇸
 Michael Shea Bulman 🇺🇸
 Marjorie & Alice Shearer 🇺🇸
 Margaret Sheehan 🇺🇸
 Kate Sheely 🇺🇸
 Jill Sherman 🇺🇸
 Greta Shultz 🇺🇸
 Jennifer Siddall 🇺🇸
 Betsy Siersma 🇺🇸
 Marc & Carol Silver 🇺🇸
 Scott & Marie Silver 🇺🇸
 Beryl Singer 🇺🇸
 Paul Siqueira 🇺🇸
 Bron Skinner 🇺🇸
 Judith Smedberg 🇺🇸

Hubbard M. & Linda F. Smith 🇺🇸
 Bob Snope & Linda Henry 🇺🇸
 Mary & Dana Snyder 🇺🇸
 Sara Snyder 🇺🇸
 Sonya Sofield 🇺🇸
 Minju Soh & Gyechul Cho 🇺🇸
 Judith Solksen 🇺🇸
 Diane Souza 🇺🇸
 Helena Spector 🇺🇸
 Nancy Spencer & Ben Bunker 🇺🇸
 Steve Stanne 🇺🇸
 Jane & Peter Stein 🇺🇸
 Patti Steinman 🇺🇸
 Linda & Roger Stenlund Moran 🇺🇸
 Robert Stern & Judith Glaser 🇺🇸
 Janice Stevens 🇺🇸
 Eric Stocker & Barbara Reily 🇺🇸
 Beverly Stone Coulombe 🇺🇸
 Jennifer Storey 🇺🇸
 Representative Ellen Story 🇺🇸
 Louis & Anna Maria Strauss 🇺🇸
 Gregory Strong 🇺🇸
 Mary Strunk Sitze & Adam Sitze 🇺🇸
 Elizabeth Sturgen 🇺🇸
 Roger & Margaret Sudbury 🇺🇸
 Virginia Sullivan 🇺🇸
 Gary & Linda Surprenant 🇺🇸
 Deborah Swan 🇺🇸
 Calvin & Joanne Swift 🇺🇸
 Norman Taft 🇺🇸
 Meghan Taylor 🇺🇸
 Kathleen & Donald Teagno 🇺🇸
 Gary & Faith Thayer 🇺🇸
 Nathan Therien & Susan Newton 🇺🇸
 Ellen Thomas 🇺🇸
 Martha Sue Thrasher 🇺🇸
 Annie Tiberio 🇺🇸
 John Tierney & Patricia Wisocki Tierney 🇺🇸
 Barbara Tiffany 🇺🇸
 Pam Tinto 🇺🇸
 William Tobey 🇺🇸
 Susan Todd 🇺🇸
 Rebecca Torrey 🇺🇸
 Eleanor Townsley & Ronald Jacobs 🇺🇸
 Richard & Margit Tracey 🇺🇸
 Kathleen Traphagen & Khalid Elkalai 🇺🇸
 Virginia Traub 🇺🇸
 Kimberly D. Tremblay & Jesse Mager 🇺🇸
 Carol Trosset 🇺🇸
 Elaine Tucker 🇺🇸
 Alicia Tuohy 🇺🇸
 Tim Van Egmond & Gale Kuhn 🇺🇸

Fred Vanderbeck & Nancy Birtwell 🇺🇸
 Juliana Vanderwielen 🇺🇸
 Fran VanTreese 🇺🇸
 Roberto Veneziani 🇺🇸
 Donald Verrastro & Heidi Dollard 🇺🇸
 Meg & Peter Vickery 🇺🇸
 Carol Vincze 🇺🇸
 Eve & Ari Vogel 🇺🇸
 Olga von Ziegesar 🇺🇸
 George & Ruth Wade 🇺🇸
 Jim Wald 🇺🇸
 Mary Wall & Byron Koh 🇺🇸
 Tanya Wallace 🇺🇸
 Amanda Walling 🇺🇸
 Sarah Warner, Warner Literary Group 🇺🇸
 Paige Warren & Lynn Adler 🇺🇸
 Janet Warren & Robert Wagner 🇺🇸
 Richard & Marion Waskiewicz 🇺🇸
 Andrew Watt 🇺🇸
 Ted Watt & Dave Gott 🇺🇸
 Mary Beth & Peter Watt 🇺🇸
 Jody Wax & Tom Butler 🇺🇸
 Sharon Wayne & Frank Welte 🇺🇸
 Ann Weisse 🇺🇸
 Laura Wenk & Judith L. Stern 🇺🇸
 Al Werner 🇺🇸
 Bob Wertzman 🇺🇸
 Catherine Wescott & Andrew Starkweather 🇺🇸
 Cindy White 🇺🇸
 Paul & Victoria Wildman 🇺🇸
 Dyan Wiley 🇺🇸
 Todd Wiley 🇺🇸
 Allison Willette & Paul Phifer 🇺🇸
 Staunton Williams, Jr. 🇺🇸
 Nancy Wilson & Nicholas Simms 🇺🇸
 Jo-Ann Wilson-Keenan & John Keenan 🇺🇸
 Irene Winkelbauer 🇺🇸
 Marie Witham 🇺🇸
 Ann Wood 🇺🇸
 Martha & Craig Woodward 🇺🇸
 Sandra Woodrow 🇺🇸
 Alia Woofenden 🇺🇸
 Elizabeth & Carl Worden 🇺🇸
 Alexander Workman 🇺🇸
 George Wright 🇺🇸
 Christopher Yerlig 🇺🇸
 Catherine Youngen 🇺🇸
 Tracy Zafian & David Schmidt 🇺🇸
 Patrick & Lisa Zephlyr 🇺🇸
 Michael Zide & Jane Winthers Zide 🇺🇸
 Cheryl Zoll & Eric Sawyer 🇺🇸
 Ximena Zuniga & Jane Mildred 🇺🇸

Leadership Gift Circle

The Leadership Gift Circle is a dedicated group of donors who partner with the Hitchcock Center by making an annual gift of \$1,000 or more. This generous yearly investment helps the Hitchcock Center pursue its vision to be a premier environmental learning center serving western Massachusetts and beyond.

Anonymous VI 🇺🇸
 Anonymous IX 🇺🇸
 Anonymous X 🇺🇸
 Anonymous XI 🇺🇸
 Neal Abraham & Donna Wiley 🇺🇸
 Harvey Allen 🇺🇸
 Dorothy & Ramon Barnes 🇺🇸
 Andrew Bellak & Susan Bain 🇺🇸
 Rema Boscov 🇺🇸
 Morgan Brill 🇺🇸
 Vivienne Carey & Roger Webb 🇺🇸
 Sabina & Norman Cournoyer 🇺🇸
 Jaana Cutson & Paul Rothenberg 🇺🇸
 Patricia Finley 🇺🇸
 Janice Gifford 🇺🇸
 Steven Gilbert 🇺🇸
 Julie & David Gross 🇺🇸
 Gordon Hall 🇺🇸
 Katherine Hammond 🇺🇸
 Bill & Vickie Hart 🇺🇸
 Mary Hocken & Ann Kearns 🇺🇸
 Jeff & Alex Lefebvre 🇺🇸
 Tom Ewing & Marilyn London-Ewing 🇺🇸
 Charles & Polly Longworth 🇺🇸
 Alice Mertz 🇺🇸
 Susan Morello & Nathan Salwen 🇺🇸
 Alan Perlmutter & Nancy Sanders, Big Sur River Inn 🇺🇸
 Dr. Victoria Pillard 🇺🇸
 Bob Saul & Katie Fretwell 🇺🇸
 Michael G. Schwartz 🇺🇸
 Pamela Stone & James Humphrey 🇺🇸
 Mary Taft & Leslie Smith 🇺🇸
 Lawrence Winship & Ellen Donkin 🇺🇸

Valley Gives (FY13)

Valley Gives is a one-of-a-kind celebration of generosity in western Massachusetts. In a 24-hour period on December 12, hundreds of local nonprofit organizations rally to raise funds for their missions, while being eligible for bonus prizes throughout the event. The top three organizations in most dollars raised and most unique number of donors also win generous prizes. During Valley Gives 2012 (FY13), our first year of participating in this event, the Hitchcock Center raised \$7,771 from 84 donors to support our award-winning environmental education programming. Thank you!

Anonymous I
 Anonymous II
 Anonymous III
 Anonymous IV
 Anonymous X
 Mike & Barbara April
 Joanna & Clay Ballantine
 Danielle Barshak & Oran Kaufman
 Ginny Brewer & Betsy Howlett
 Steven Brown & Lisa Oram
 Merle S. Bruno & Peter Vincent
 Sam & Ian Camera
 Elisa K. Campbell
 Elaine Cat & Richard Loomis
 Casey Clark
 Cathy & Joe Cohen
 Sara B. Cooper & Jon Chamutka
 Rebecca Reid & Michael Dover
 Mary & David Dunn
 Nancy Eddy
 Kent Faerber
 Rachel Fink & Tom Dennis
 Jackie & Carl Fiocchi
 Barbara Francis & Al Woodhull
 Janice Gifford
 Peggy Gillespie
 Nancy Goodman
 Julie & David Gross
 Charles & Susan Haight
 Shirley Hammerschmidt
 Bill & Vickie Hart
 Julie H. HawkOwl
 Susan Heitker & Mathew Jacobson
 Kenneth & Lauren Holt

John Hoops
 Ruthie & Michael Ireland
 Julie M. Johnson
 Colleen Kelley & David Perlmutter
 Ellen Leuchs, KirschLeuchs Consulting
 Katie Koerten & Matt Valliere
 John Kowaleski & Erin Baker
 Sarah & Niels la Cour
 Jim Laflay & Sharon Wood
 Lyssia Lamb-MacDonald
 Stacey Lennard & Stephen Saxenian
 Ellen Leuchs
 Christine Lindeman
 Paul & Marcelle Lipke
 Tom Ewing & Marilyn London-Ewing
 Susan Loring-Wells & Marty Wells
 John & Cathy Manly
 Nora & Tony Maroulis
 Sarah & Douglas Marshall
 Jenifer McKenna & Gerald Weiss
 Ralph & K.C. Murphy
 Rick Gerstein & Patty O'Donnell
 Robert Peck
 Dr. Victoria Pillard
 Mark Protti & Michele Sedor
 Deborah Reiter
 Ann Romberger & Martha Ackmann
 Elissa & Bernie Rubinstein
 Lauret Savoy
 Jessica Schultz
 Margaret Sheehan
 David Spector & Magda Bechar
 Elizabeth Sturgen
 Richard & Mary Thayer
 Marylou Theilman
 William Tobey
 Jennifer & Steve Unkles
 Juliana Vanderwielen
 Pamela C. Victor
 Eve & Ari Vogel
 Jim Wald
 Ted Watt & Dave Gott
 Pete Westover
 Dyan Wiley
 Christopher Yerlig
 Erika Zekos & Derek Noble
 Daniel & Emily Ziomek
 Cheryl Zoll & Eric Sawyer

Multi-Year breakout—

Annual & Capital Campaign Gifts
 Special thanks to those who have pledged gifts over multiple years. Your long-term financial commitment gives the Hitchcock Center the confidence it needs to be responsive to future needs.

Anonymous VI
 Anonymous IX
 Anonymous X
 Anonymous XI
 Harvey Allen
 Penny Beebe
 Andrew Bellak & Susan Bain
 Jane & Steven Brown
 Margaret Bullitt-Jonas & Robert Jonas
 Casey Clark
 Jaana Cutson & Paul Rothenberg
 Michael Dover & Rebecca Reid
 Nancy Eddy
 Judith Espinola & Susan Perry
 Rachel Fink & Tom Dennis
 Janice Gifford
 Charles Haight & Susan McDonald Haight
 Caroline & Howard Hanna
 Marie Hess
 Mary Hocken & Ann Kearns
 Julie M. Johnson
 Melissa Kroodsmas
 Sarah & Niels la Cour
 Susan Loring-Wells & Marty Wells
 Lynn Pasquerella & John Kuchle
 Lorna & Dale Peterson
 Alexander & Harriet Pollatsek
 Ann Romberger & Martha Ackmann
 Bob Saul & Katie Fretwell
 Michael G. Schwartz
 Pamela Stone & James Humphrey
 Alice Swift
 Mary Taft & Leslie Smith
 Gordon Thorne & Annie Woodhull
 Donna Wiley & Neal Abraham
 Ellen Donkin & Lawrence Winship
 Nancy & Don Wise
 Daniel & Emily Ziomek

Business Gifts
 A. J. Hastings, Inc. 🇺🇸
 Amherst Farmers Supply 🇺🇸
 Amherst Landscape Design 🇺🇸
 Amherst Welding 🇺🇸
 Boisselle, Morton & Associates, LLP 🇺🇸
 Boyden & Perron, Inc. 🇺🇸
 Bulkley, Richardson and Gelinas, LLP 🇺🇸
 Conservation Works, LLC 🇺🇸
 Davis Financial Group 🇺🇸
 E.S.P. Auto, Inc. 🇺🇸
 Encharter Insurance, LLC 🇺🇸
 Finck and Perras Insurance Agency, Inc. 🇺🇸
 Florence Savings Bank 🇺🇸
 Good Search 🇺🇸
 Greenfield Savings Bank 🇺🇸
 Hadley Garden Center 🇺🇸
 Hope & Feathers Framing 🇺🇸
 Integrity Development Construction 🇺🇸
 J.F. Conlon & Associates 🇺🇸
 Kamins Real Estate 🇺🇸
 KirschLeuchs Consulting 🇺🇸
 Kraus-Fitch Architects 🇺🇸
 Kuhn-Riddle Architects 🇺🇸
 Lord Jeffery Inn 🇺🇸
 Michael Shea Bulman, Attorney at Law 🇺🇸
 New England Environmental, Inc. 🇺🇸
 Northampton Cooperative Bank 🇺🇸
 Pelham Auto Service/
 Pelham Industrial Group 🇺🇸
 PeoplesBank 🇺🇸
 Sandri Energy, LLC 🇺🇸
 Seewald, Jankowski, & Spencer P.C. 🇺🇸
 Sinauer Associates, Inc. 🇺🇸
 Singer Potito Associates 🇺🇸
 Sumner Heating Co., Inc. 🇺🇸
 Teagno Construction, Inc. 🇺🇸
 Thomson Financial Management Inc. 🇺🇸
 Trademark Real Estate, LLC 🇺🇸
 Valley Veterinary Hospital & Inn for Pets 🇺🇸
 Vanasse Hangen Brustlin, Inc. 🇺🇸
 Whalen Insurance 🇺🇸
 Wilson Services, Inc. 🇺🇸
 Wright Builders, Inc. 🇺🇸

In-Kind Gifts

Boisselle, Morton & Associates, LLP 🇺🇸
 Bulkley, Richardson and Gelinas, LLP 🇺🇸
 Collective Copies 🇺🇸
 Kyle Forbes Bissell 🇺🇸
 Daily Hampshire Gazette 🇺🇸
 Ronna Erickson 🇺🇸
 Hadley Garden Center 🇺🇸
 Nancy Goodman 🇺🇸
 Henry Leuchtmann 🇺🇸
 Lord Jeffery Inn 🇺🇸
 Town of Amherst 🇺🇸

Matching Gifts

Anonymous Fund 🇺🇸
 Anonymous Fund II 🇺🇸
 Grantham, Mayo, Van Otterloo & Co. 🇺🇸

Fiscal Year 2012 🇺🇸 Fiscal Year 2013 🇺🇸

Memorial Gifts

IN MEMORY OF
 Elizabeth "Betty" Borgeois
 Benson Bowditch
 Christopher Burrage
 David Collette
 Ethel DuBois
 Alice Epstein
 Margaret Frerichs
 Samuel Green

William Xander Mar
 Bob McClung

GIVEN BY

Dana & Mary Snyder
 Elaine P. Bowditch
 Bonita & Robert Krotkov
 Elaine Beilin & Robert Brown
 Andrea Wright & Peggy Anderson
 Seymour Epstein
 Katharine Reichert
 Dorothy & Ramon Barnes, Margaret & Al Bernstein,
 Lisa Bertoldi & William Sayre, Rema Boscov, Joann Breuer,
 Vivienne Carey & Roger Webb, Annie Cheatham & Ann Gibson,
 Jaana Cutson & Paul Rothenberg, Caitlin Darfler & Ben Lippincott,
 Marlaine & Richard Darfler, Ruth Feldberg, Heather Hart,
 Mary Jones, Colleen Kelley, Katie Koerten, Northfield Sitting Group,
 Nancy Paglia, Elissa & Bernie Rubinstein, Jennifer Ryan,
 Jessica Schultz, Sonya Sofield, Jennifer Unkles
 Anna Martini & Maria Kopicki
 David & Anne Goehring

Honorary Gifts

IN HONOR OF
 Michael April
 Casey Clark
 Bill Hart
 Colleen Kelley
 Katie Koerten
 Paul Lipman
 Josh Parker
 Cynthia Patterson
 Korinna Spirko
 Hanna & Emily Worpek

GIVEN BY

Integrity Development Construction
 Kenneth Rosenthal
 The Trustees of Reservations
 Alan Perlmutter & Nancy Sanders, Elaine Tucker
 Rebecca Miller & Tom Randall
 William & Theresa Rock
 Joanne Parker
 Martha F. Hoopes
 Traci Hess & John Wells, Kathleen Traphagen & Khalid Elkalai
 Bonita & Robert Krotkov



REVENUE

	FY2012	FY2013
Contributed support	\$124,722.00	\$188,483.00
Grant	\$93,605.00	\$599,868.00
Earned revenue	\$248,743.00	\$291,804.00
Membership	\$15,240.00	\$13,880.00
Other	\$358.00	\$355.00
	\$482,668.00	\$1,094,390.00

EXPENSES

	FY2012	FY2013
General operations	\$57,930.00	\$94,059.00
Development	\$49,879.00	\$56,980.00
Green Building Fund	\$122,615.00	\$220,057.00
Program	\$286,312.00	\$308,865.00
	\$516,736.00	\$679,961.00

Figures based on audited financial statements for FY12 and FY13.

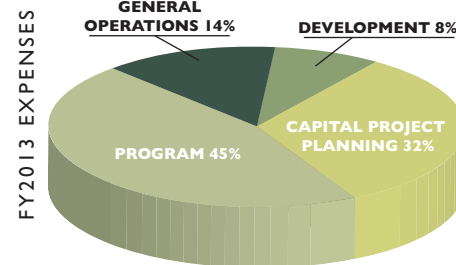
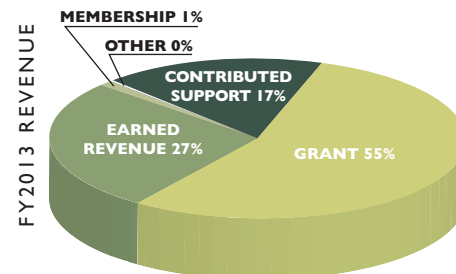
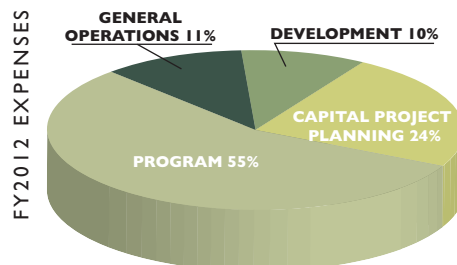
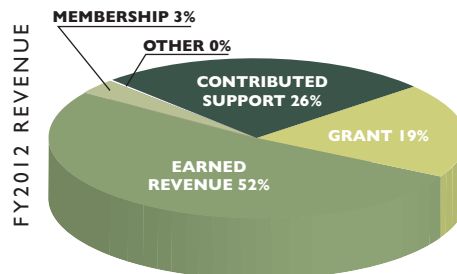



**Hitchcock Center for the Environment
at Larch Hill Conservation Area**

525 South Pleasant Street
Amherst, MA 01002

413-256-6006

Public Hours:
Tuesday–Friday
9:00 AM–4:00 PM

www.hitchcockcenter.org



United Way
of Hampshire County



massculturalcouncil.org



Photography: Jessica Schultz & Rebecca Reid
Anniversary logo design: Peter Gariepy

Printed on recycled paper.

